

Project Name: \_\_\_\_\_  
 Location: \_\_\_\_\_  
 Engineer: \_\_\_\_\_  
 Submitted to: \_\_\_\_\_  
 Submitted by: \_\_\_\_\_  
 Reference: \_\_\_\_\_

Approval: \_\_\_\_\_  
 Date: \_\_\_\_\_  
 Construction: \_\_\_\_\_  
 Unit #: \_\_\_\_\_  
 Drawing #: \_\_\_\_\_

## **Performance**

*Indoor Unit Model No:* FXTQ42PAVJU  
*Cooling Capacity (Btu/hr):* 42000  
*Sensible Capacity (Btu/hr):* 27694  
*Cooling Input Power (kW):* 0.473  
*Heating Capacity (Btu/hr):* 47000  
*Heating Input Power (kW):* 0.473  
*Nominal Ext Static Pressure (inH2O):* 0.3  
*Max Ext Static Pressure (inH2O):* 0.5

*Indoor Unit Type:* Vertical Air Handler (and Horizontal R)  
*Cooling Nominal Conditions* Indoor: 80°F DB/67°F WB  
 Outdoor: 95°F DB/75°F WB  
*Heating Nominal Conditions* Indoor: 70°F DB/60°F WB  
 Outdoor: 47°F DB/43°F WB  
*Nominal Piping Length* 25  
*Nominal Height Separation* 0

## **Indoor Unit Details**

*Power Supply (V/Hz/Ph):* 208-230/60/1ph  
*Power Supply Connections:* L1, L2, Ground  
*Min. Circuit Amps MCA (A):* 4  
*Max. Fusible Amps MFA (A):* 15  
*Dimensions (HxWxD):* 53-1/4x22x24  
*Panel (HxWxD):* N/A  
*Net Weight (lbs):* 167  
*Weight with Panel (lbs):* \_\_\_\_\_

*Airflow Rate (CFM wet coil)* 1400//980  
*Moisture Removal (pt/h):* \_\_\_\_\_  
*Gas Pipe Connection (inch):* 5/8  
*Liquid Pipe Connection (inch):* 3/8  
*Condensate Connection (inch):* 3/4 FPT  
*Sound Pressure Level (dBA):* \_\_\_\_\_  
*Sound Power Level (dBA):* \_\_\_\_\_

## **Appearance - Indoor Unit**



# Submittal Data Sheet

Project Name: \_\_\_\_\_  
 Location: \_\_\_\_\_  
 Engineer: \_\_\_\_\_  
 Submitted to: \_\_\_\_\_  
 Submitted by: \_\_\_\_\_  
 Reference: \_\_\_\_\_

Approval: \_\_\_\_\_  
 Date: \_\_\_\_\_  
 Construction: \_\_\_\_\_  
 Unit #: \_\_\_\_\_  
 Drawing #: \_\_\_\_\_

### Dimensional Drawing - Indoor Unit

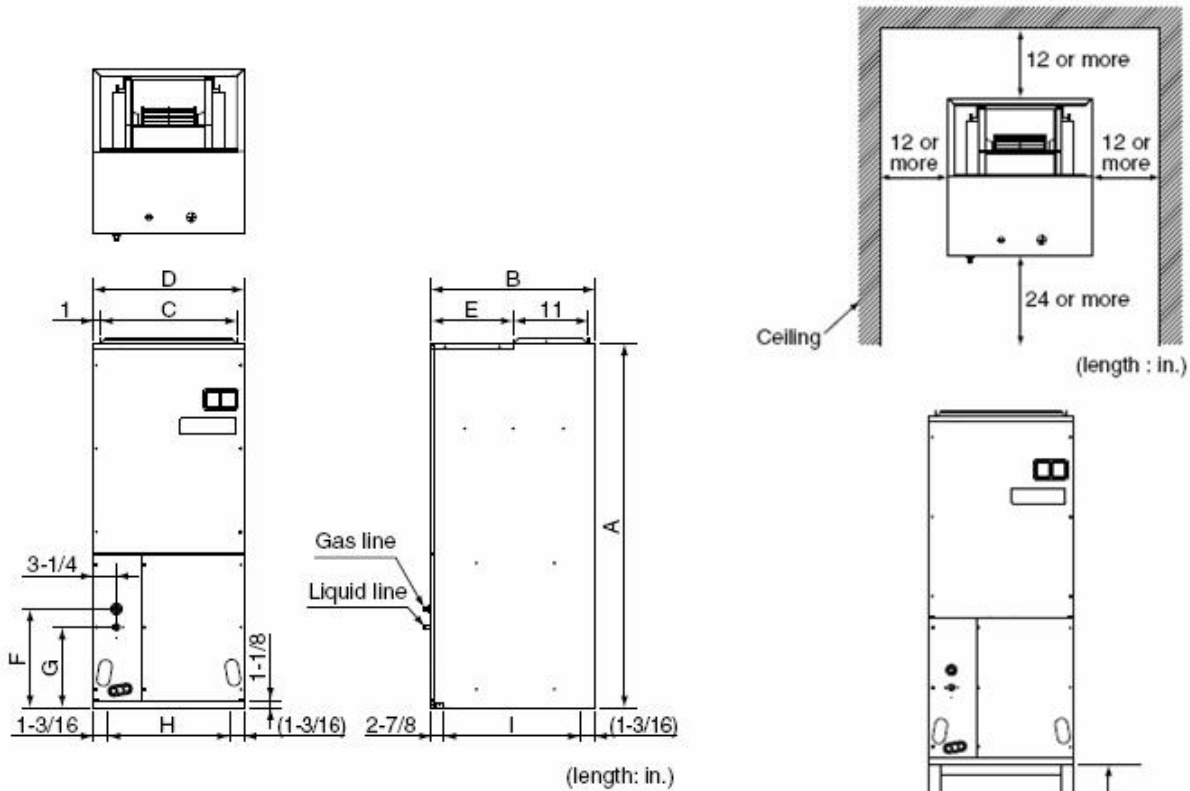

Model	A	B	C	D	E	F	G	H	I
12 · 18 type	46-3/4	22	17-1/2	19-1/2	10	14-1/2	11-15/16	17-1/8	17-15/16
24 · 30 · 36 · 42 · 48 · 54 type	53-3/4	24	20	22	12	19-5/8	11-15/16	19-5/8	19-15/16

- Ensure sufficient space for the bottom of the product (H dimensions) so that a downward slope of 1/100 can be maintained for drain piping, as described for the intake duct installation and in "6. DRAIN PIPING WORK".

Project Name: \_\_\_\_\_  
Location: \_\_\_\_\_  
Engineer: \_\_\_\_\_  
Submitted to: \_\_\_\_\_  
Submitted by: \_\_\_\_\_  
Reference: \_\_\_\_\_

Approval: \_\_\_\_\_  
Date: \_\_\_\_\_  
Construction: \_\_\_\_\_  
Unit #: \_\_\_\_\_  
Drawing #: \_\_\_\_\_

## Notes

Requires KRCS01-4B (or BRC1E71), Limited to 100% connection index on VRVIII-S, VRV-WIII and VRV-III-C, Std U.S. Warranty: 6yrs Compressor, 1yrs Parts, 1yr Limited Labor